

A guide for young people visiting the Fitzwilliam Museum either with their family or as independent visitors. It offers young people a taste of the collection in each of our main first floor galleries. With:

- Ideas on how to 'read' art
- Conversation starting points
- Connecting the collection with studies in Art, History, English, Religious Studies
- Themes to explore
- Creative practice

Information about our young people's programme:  
[www.fitzmuseum.cam.ac.uk/learning/youngpeople](http://www.fitzmuseum.cam.ac.uk/learning/youngpeople)

#### First Floor

- 1 British & European Art 19th-20th centuries
- 2 British Art 19th century
- 3 British Art 16th-18th centuries
- 4 French Art 17th-19th centuries
- 5 French Art 19th-20th centuries
- 6 Italian Art 14th-16th centuries
- 7 Italian Art 16th-18th centuries
- 8 Spanish & Flemish Art 16th-18th centuries
- 10 Octagon Gallery
- 11 The Arts of the 20th century
- 12 Adeane Gallery
- 13 Mellon Gallery
- 14 Shiba Gallery
- 15 Dutch Art 17th-18th centuries
- 16 Charrington Print Room
- 17 Flower Paintings

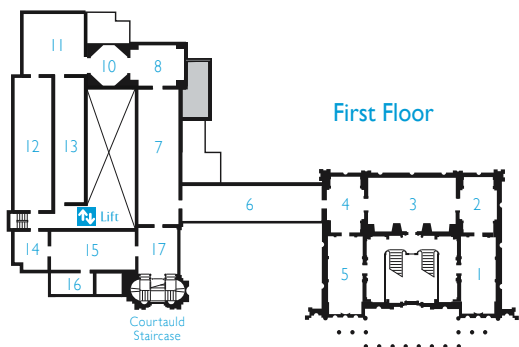

#### Ground Floor

- 19 Egypt
- 20 Egypt
- 21 Greece & Rome
- 22 Cyprus
- 23 Ancient Near East
- 25 Founder's Library
- 26 European & Japanese Porcelain
- 27 European Pottery
- 28 The Arts of the Far East
- 29 The Arts of Korea
- 31 Armoury
- 32 Medieval & Renaissance Art
- 33 The Arts of the Near East
- 34 Sasakawa Fan Gallery

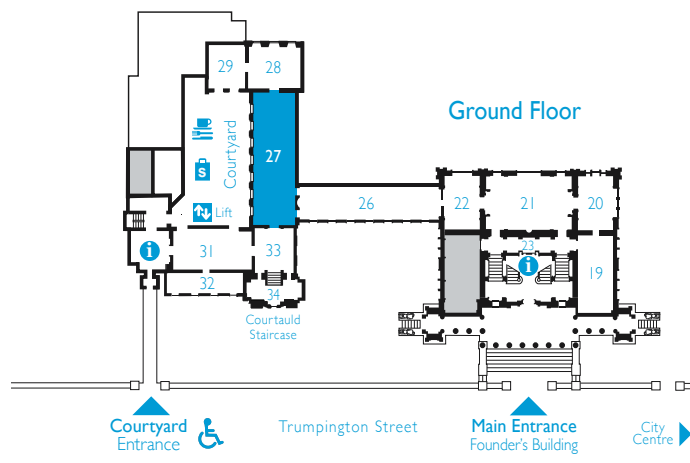

The  
Fitzwilliam  
Museum  
CAMBRIDGE

Cover image: Merete Rasmussen, *Blue Twisted Form*, 2011 (detail) © The artist



Supported using public funding by  
ARTS COUNCIL  
ENGLAND

# 27 GALLERY

## ART GUIDE

### FOR TEENS

A GALLERY INTRODUCTION



The  
Fitzwilliam  
Museum  
CAMBRIDGE

## KEY IDEAS

Abstract ceramic and glass • Applied art objects  
Pattern • Colour • Shape • Texture

Artists you like in this gallery

Art materials and techniques used

### TALKING POINTS

Find two objects in the gallery - **one functional and one decorative**. Describe and contrast them.

You could write it up as an art blog post for other young artists like you.

### SKETCH UP

Using coloured drawing pencils, record the shapes and forms of these art works. Put your drawings on one page and let them overlap each other.

Draw the spaces some of the work like the Merete Rasmussen's *Blue Twisted Form* ceramic create or look at the handles on pots, cups and the spaces between objects on shelves and in cases.

### WORD UP

Choose one object choose any of these words that you think describes it:

thoughtful • intriguing • lonely • noisy • dramatic  
quiet • sociable • beauty • clean • rowdy • fun  
serious • lively • busy • hot • aggressive • cool  
unusual • happy • upside-down • ideas • joyful  
strong • powerful • dark • stark • confusing  
musical • silent • peaceful • glowing • brooding  
cold • sad • boyant • sophisticated • naive

### BACK IN YOUR STUDIO

Experiment with acrylic paint applied to thick cardboard or mount board, use different tools to create marks and texture and think about your colour palette. It can be warm or cool, calm or energetic.

### NOTEPAD

## EXPLORING YOUR IMAGINATION

In the same display case as the *Blue Twisted Form* is this glass artwork by Colin Reid, *Pyramid Form*, 1997.

This dynamic artwork has such a strong form and clean edges in contrast to the misty fluid shapes inside.

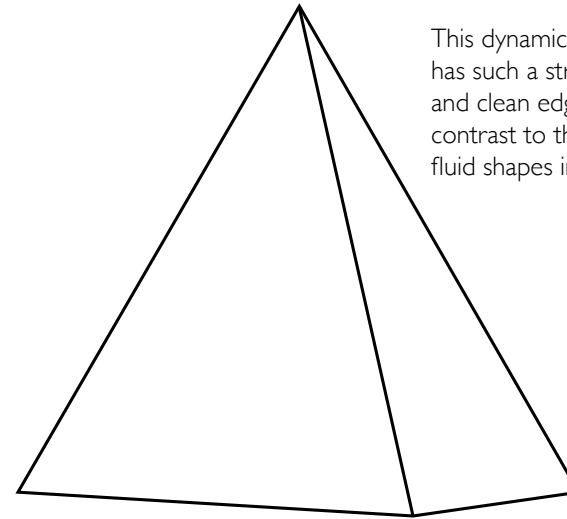

Try creating some of these flowing shapes using sweeping lines with your pencils.

Use this space to sketch your own ceramic sculpture ideas inspired by the objects in this gallery.